

### IMPORTANT NOTICE AMENDMENT OF BOOTH LIGHTING SPECIFICATIONS

ALL LIGHTS SPECIFIED AS 23 WATT ENERGY SAVING LAMP (BOTH SPOTLIGHT/LONGARMED) ON THIS DRAWING WILL BE CHANGED TO **13 WATT LED LAMPS**, WITH EFFECT ON THE 1<sup>st</sup> of JANUARY 2019.

### 117 Sq.m. Peninsula Booth (A)

117平方米半島攤位 (A)

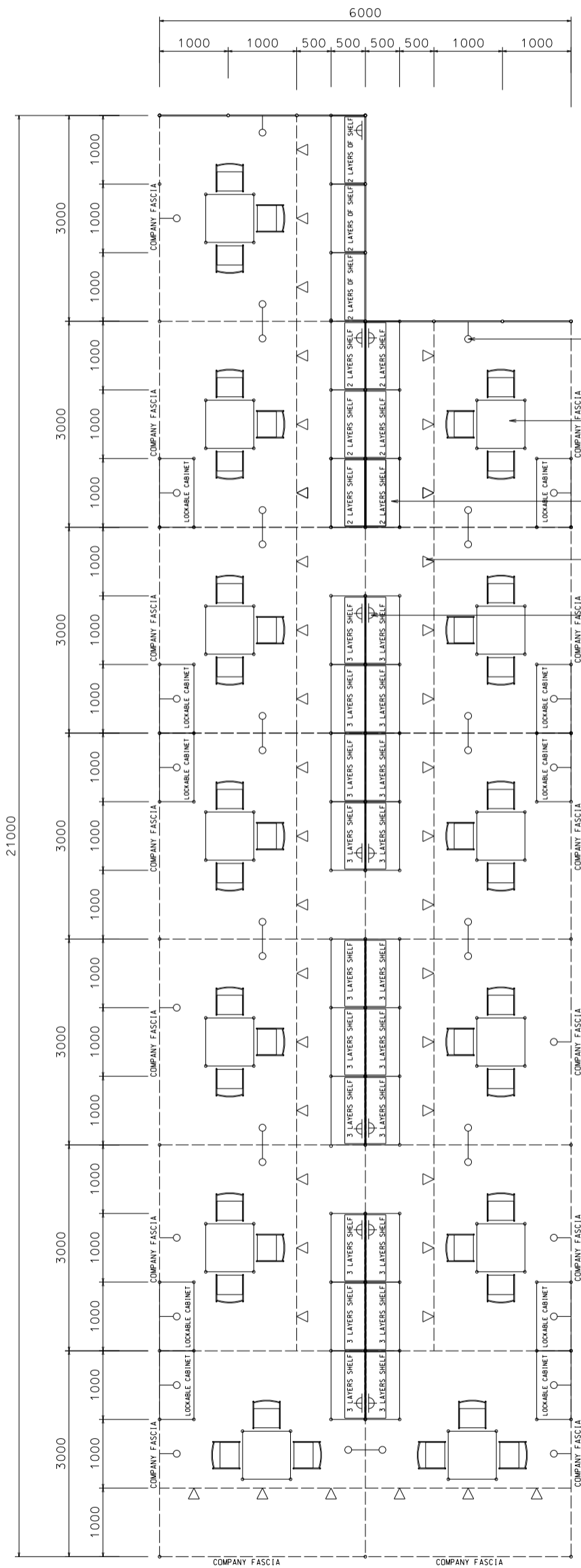

- 23W ENERGY SAVING LAMP LONGARMED SPOTLIGHT (YELLOW LIGHT)
- 700X700X750H MEETING TABLE W/. 3 LEATHER CHAIRS
- LOCKABLE CABINET W/. 2 LAYERS OF SLANTING SHELF
- 23W ENERGY SAVING LAMP SPOTLIGHT (YELLOW LIGHT)
- 500W SOCKET



BOOTH SPECIFICATIONS		QTY.
	1000W x 500D x 750H CABINET	39
	2000W x 300D SLOPE WOODEN DISPLAY SHELF	12
	3000W x 300D SLOPE WOODEN DISPLAY SHELF	18
	23W ENERGY SAVING LAMP SPOTLIGHT (YELLOW LIGHT)	39
	23W ENERGY SAVING LAMP LONGARMED SPOTLIGHT (YELLOW LIGHT)	39
	700W x 700D x 750H MEETING TABLE	13
	BLACK LEATHER CHAIR	39
	CEILING BEAM	74M
	500W SOCKET	13
RUBBISH BIN & CARPET (117sqm.)		

\*The Hong Kong Trade Development Council reserves the right to change the configuration if necessary.

\*如有需要，香港貿易發展局有權更改攤位結構。

### IMPORTANT NOTICE AMENDMENT OF BOOTH LIGHTING SPECIFICATIONS

ALL LIGHTS SPECIFIED AS 23 WATT ENERGY SAVING LAMPS (BOTH SPOTLIGHT/LONGARMED) ON THIS DRAWING WILL BE CHANGED TO **13 WATT LED LAMPS**, WITH EFFECT ON THE 1<sup>st</sup> of JANUARY 2019.

# A

## 117 Sq.m. Odd Size Peninsula Booth (A)

## 117平方米半島攤位 (A)

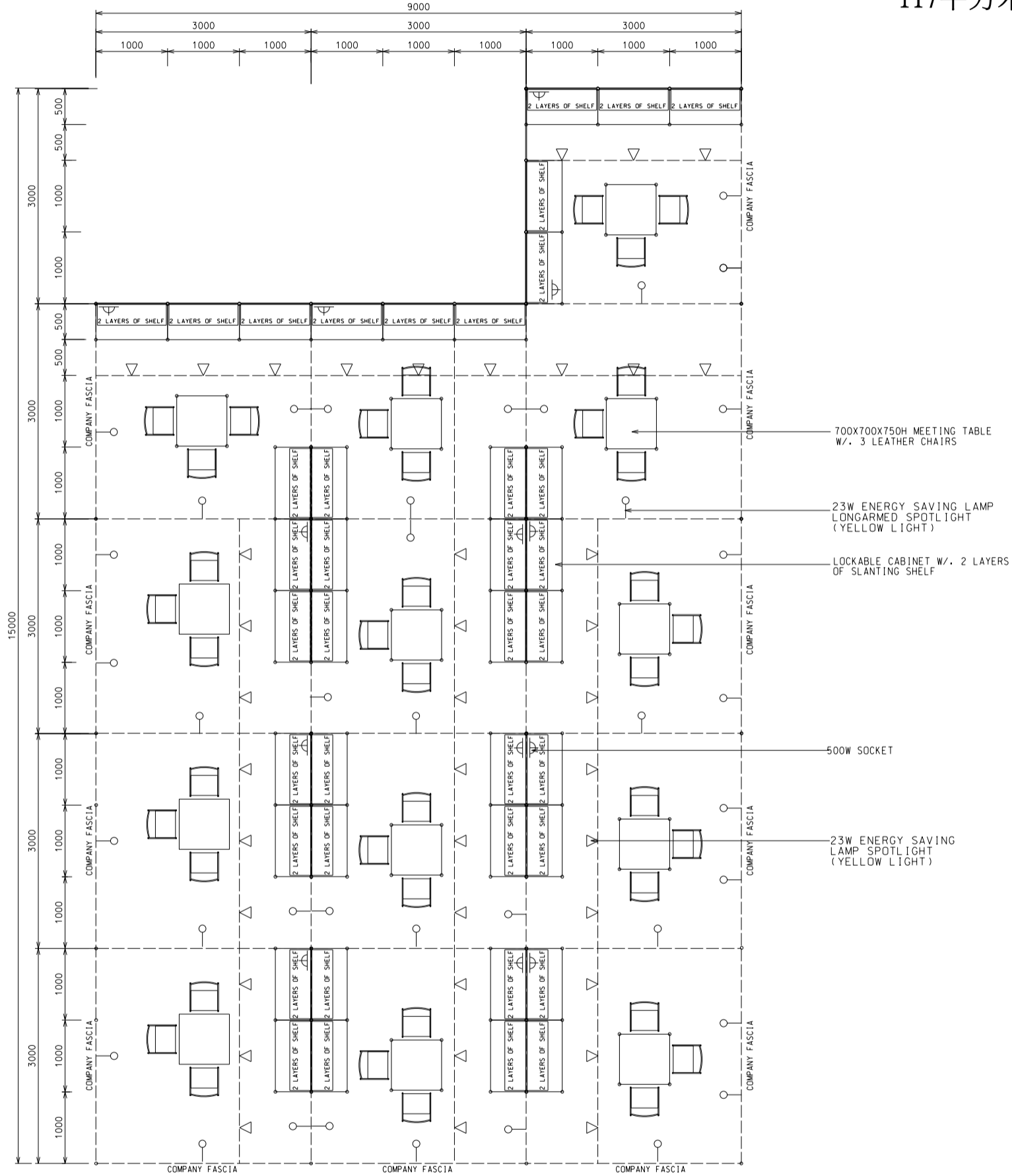

PLAN

BOOTH SPECIFICATIONS		QTY.
	1000W x 500D x 750H CABINET	39
	3000W x 300D SLOPE WOODEN DISPLAY SHELF	14
	2000W x 300D SLOPE WOODEN DISPLAY SHELF	18
	23W ENERGY SAVING LAMP SPOTLIGHT (YELLOW LIGHT)	39
	23W ENERGY SAVING LAMP LONGARMED SPOTLIGHT (YELLOW LIGHT)	39
	700W x 700D x 750H MEETING TABLE	13
	BLACK LEATHER CHAIR	39
	CEILING BEAM	82M
	500W SOCKET	13
RUBBISH BIN & CARPET (117sqm.)		

**IMPORTANT NOTICE**  
**AMENDMENT OF BOOTH LIGHTING SPECIFICATIONS**

ALL LIGHTS SPECIFIED AS 23 WATT ENERGY SAVING LAMPS (BOTH SPOTLIGHT/LONGARMED) ON THIS DRAWING WILL BE CHANGED TO **13 WATT LED LAMPS**, WITH EFFECT ON THE 1<sup>st</sup> OF JANUARY 2019.

### B

### 117 Sq.m. Odd Size Standard Booth (A)

### 117平方米標準攤位(A)

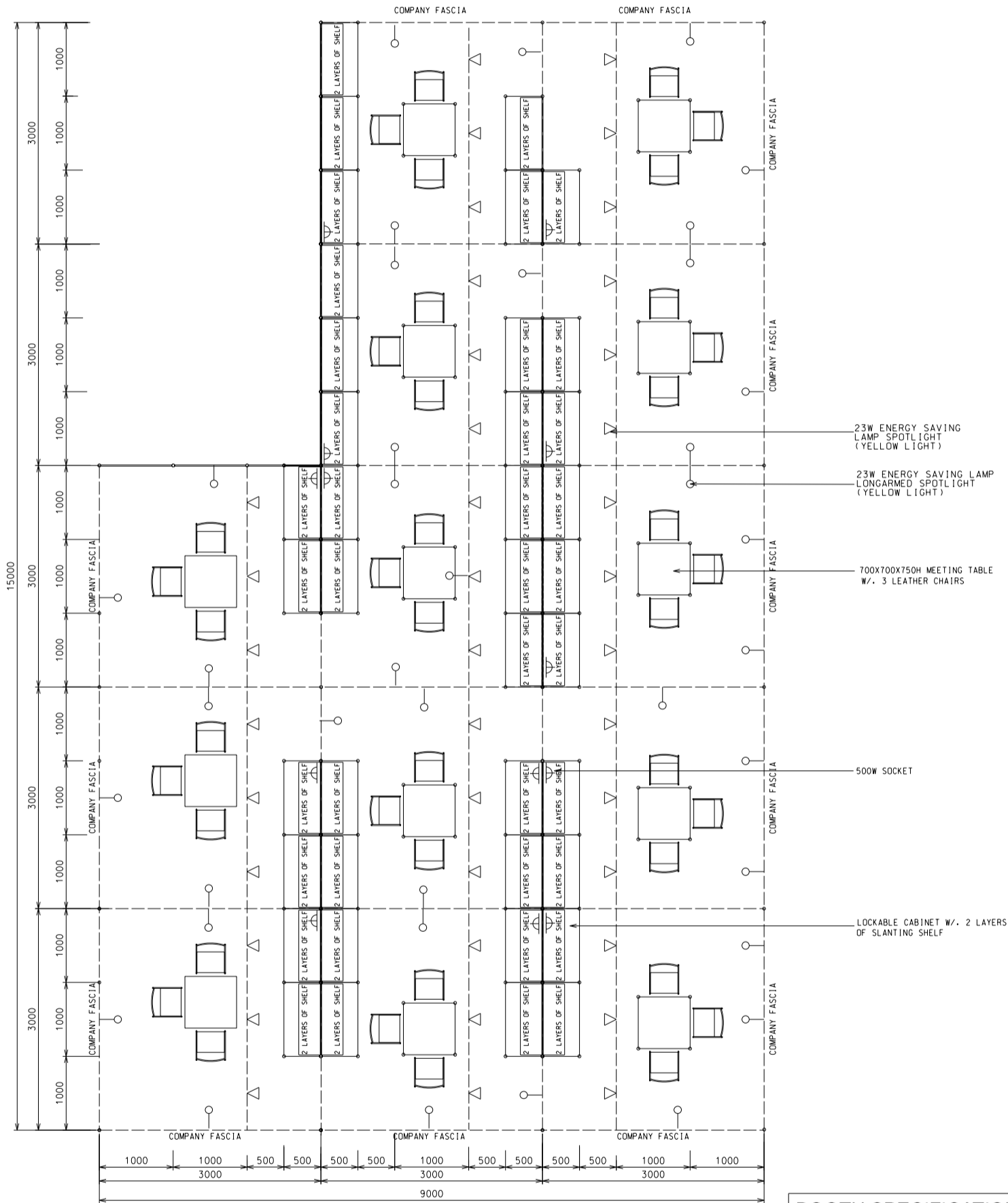

PLAN

BOOTH SPECIFICATIONS		QTY.
	1000W x 500D x 750H CABINET	39
	1000W x 300D SLOPE WOODEN DISPLAY SHELF	2
	2000W x 300D SLOPE WOODEN DISPLAY SHELF	26
	3000W x 300D SLOPE WOODEN DISPLAY SHELF	8
	23W ENERGY SAVING LAMP SPOTLIGHT (YELLOW LIGHT)	39
	23W ENERGY SAVING LAMP LONGARMED SPOTLIGHT (YELLOW LIGHT)	39
	700W x 700D x 750H MEETING TABLE	13
	BLACK LEATHER CHAIR	39
	CEILING BEAM	76M
	500W SOCKET	13
RUBBISH BIN & CARPET (117sqm.)		

\*The Hong Kong Trade Development Council reserves the right to change the configuration if necessary.

### IMPORTANT NOTICE

#### AMENDMENT OF BOOTH LIGHTING SPECIFICATIONS

ALL LIGHTS SPECIFIED AS 23 WATT ENERGY SAVING LAMPS (BOTH SPOTLIGHT/LONGARMED) ON THIS DRAWING WILL BE CHANGED TO **13 WATT LED LAMPS**, WITH EFFECT ON THE 1<sup>ST</sup> OF JANUARY 2019.

# C

## 117 Sq.m. Odd Size Standard Booth (A)

### 117平方米標準攤位 (A)

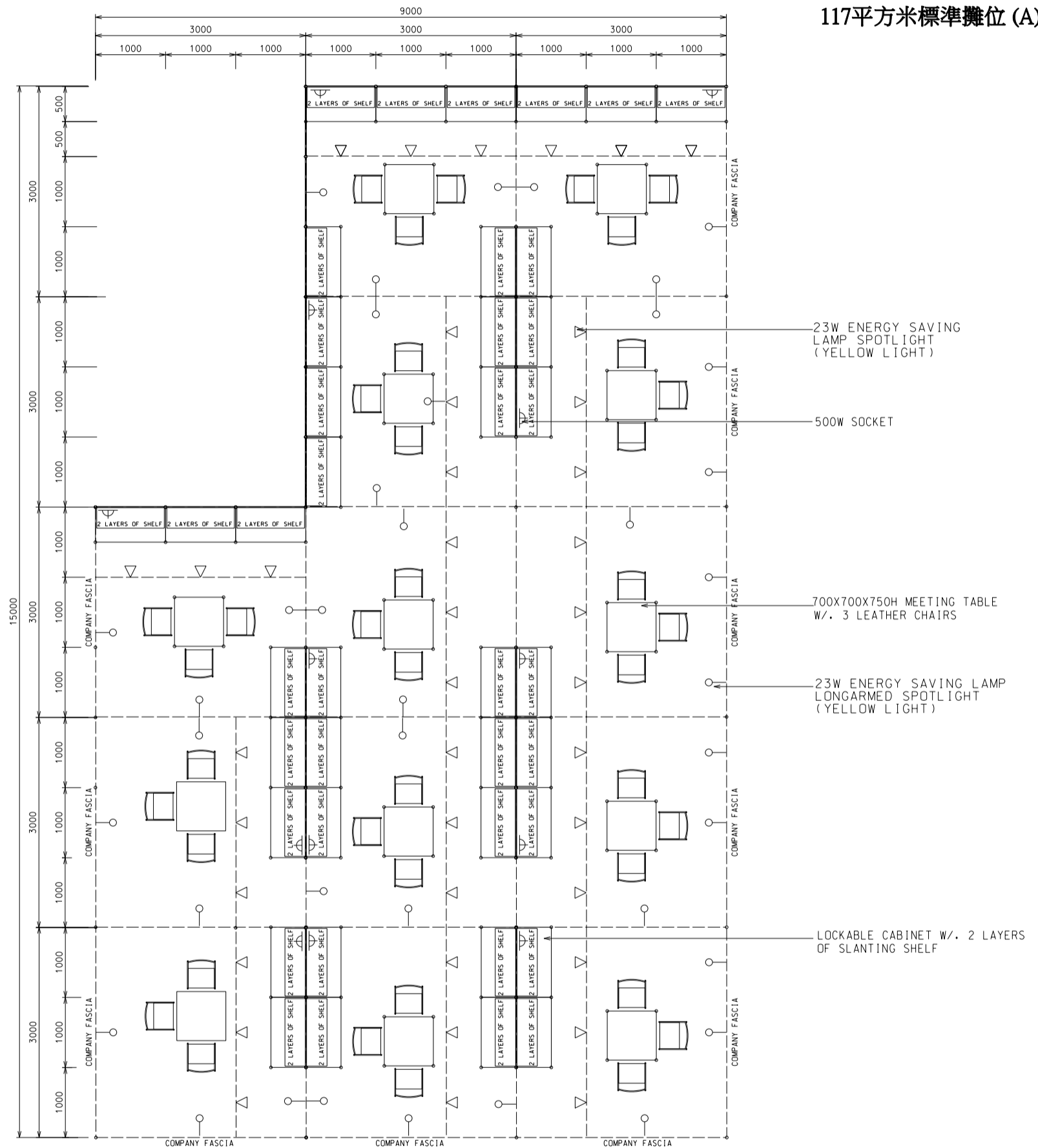

BOOTH SPECIFICATIONS		QTY.
	1000W x 500D x 750H CABINET	39
	3000W x 300D SLOPE WOODEN DISPLAY SHELF	18
	2000W x 300D SLOPE WOODEN DISPLAY SHELF	12
	23W ENERGY SAVING LAMP SPOTLIGHT(YELLOW LIGHT)	39
	23W ENERGY SAVING LAMP LONGARMED SPOTLIGHT (YELLOW LIGHT)	39
	700W x 700D x 750H MEETING TABLE	13
	BLACK LEATHER CHAIR	39
	CEILING BEAM	80M
	500W SOCKET	13
	RUBBISH BIN & CARPET (117 sqm.)	

\*The Hong Kong Trade Development Council reserves the right to change the configuration if necessary.

\*如有需要，香港貿易發展局有權更改攤位結構。